

电机基本规范 Motor Specification

项目 Item	三相电机 3-Phase Motor	单相电机 1-Phase Motor
防护等级 Protection	铝合金接线盒为IP54,铁壳接线盒为IP20 IP54 With Alum Alloy Terminal Box, And Other Is IP20	
外壳材质 Frame Material	100W~3700W机壳为铝合金, 1#, 2#, 3#, 4#齿轮箱为铝合金, 5#, 6#齿轮箱为铸铁 Alum Alloy For 100W~2200W Frame, Alum Alloy For 1#, 2#, 3#, 4#Gear Case, 5#, 6# Cast Iron For Others	
工作方式 Duty	连续运转/Continuous running S1工作制 Duty: S1	
绝缘等级 INS.Class	B级(F级)可选/Optional 常规B级 (F级可选) Regular class B (Class F can choose)	
适用环境 Environment	温度/Temp:-10°C~+40°C 湿度/Humidity:≤90%	
使用电压 Voltage	220-240/380-415V,50/60Hz	110V/50/60Hz,220V/50/60Hz
极数 Pole	4P(6P)	4P
海拔 Height	≤1000m	
起动方式 Starting	全压起动 Direct Start	0.1-0.2KW单电容起动 Capacitor 0.4-1.5KW双电容起动 Double Capacitors
依据标准 Standard	GB755/IEC-60034	

单相电机配套电容值, 电容运转形式 Capacitor For 1-phase Motor, C-running Type

输出功率 Output Power	运转电容 Running Capacitor	起动电容 Starting Capacitor	运转电容+起动电容(离心开关) Running + Starting Capacitor(Centrifugal Switch)
100W,1/8 hp	8μF/450V	/	/
200W,1/4 hp	12μF/450V	/	/
400W,1/2 hp	/	/	15μF/450V+75μF/250V
750W,1 hp	/	/	20μF/450V+150μF/250V
1500W,2 hp	/	/	40μF/450V+200μF/250V

刹车性能说明 Function For Brake Unit

输出功率 Output Power	允许最高转速 Permit Max Rpm	刹车制动力 Torque(kg.m)	刹车间隙 Clearance(mm)	重量 Weight(kg)
1/8HP4P-1/4HP4P(100W-200W)	4000	0.15-0.4	0.3-0.5	2.0
1/2HP4P-1HP4P(400W-750W)	3600	0.25-0.7	0.4-0.6	4.3
1.5HP4P-2HP4P(1100W-1500W)	3600	0.92-2.0	0.5-0.7	6.3
3HP4P-5HP4P(2200W-3700W)	3600	1.80-3.5	0.6-0.8	7.0

接线方式 WIRING DIAGRAM

三相电机接线方式 FOR 3-PHASE MOTOR

三相电机接线方式 FOR 3-PHASE MOTOR

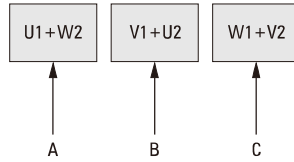

△接法/220V-240V

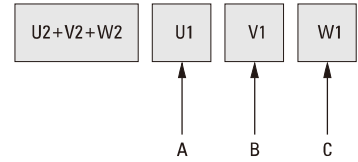

Y接法/380V-415V

三相电机与刹车器接线方式 THE CONNECTION MODE FOR THREE PHASE MOTOR AND BRAKE

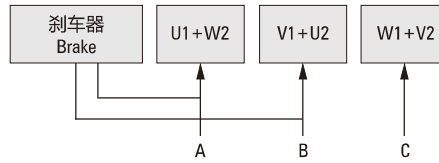

△接法/220V-240V

※注: 刹车器两根电源线接任意两根接线端
Note: Brake wires can connect to either pin

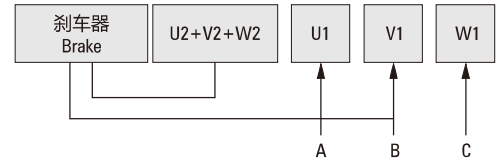

Y接法/380V-415V

※注: 刹车器电源线一根接电机公共端, 另外一根接电机任意一组
Note: One of brake wire connect to motor public and the other wire connects to either motor wire

单相电机接线方式 FOR 1-PHASE MOTOR C表示电容 C FOR CAPACITOR

单相电机接线方式 FOR 1-PHASE MOTOR

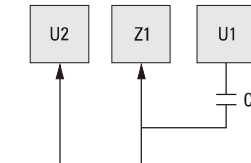

100W/200W逆时针接法/CCW Connection

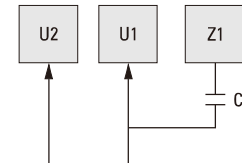

100W/200W顺时针接法/CW Connection

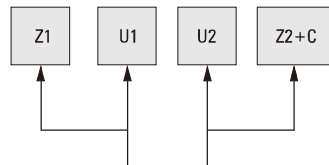

400W/750W/1500W顺时针接法/CW Connection

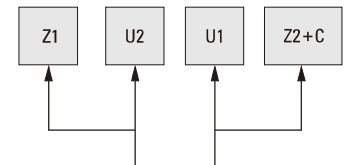

400W/750W/1500W逆时针接法/CCW Connection

单相电机与刹车器接线方式 THE CONNECTION MODE FOR SINGLE PHASE MOTOR AND BRAKE

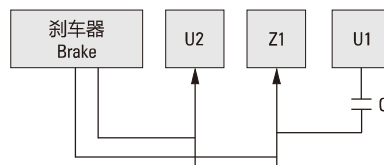

100W/200W逆时针接法/CCW Connection

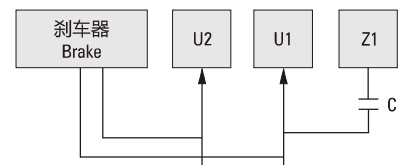

100W/200W顺时针接法/CW Connection

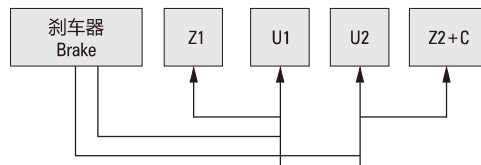

400W/750W顺时针接法/CW Connection

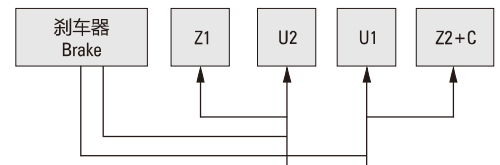

400W/750W逆时针接法/CCW Connection

※备注: 电机变频时, 刹车器请单独接电源。电机使用频率低于30Hz时, 必须带轴流风机, 轴流风机须单独接电源。

※Note: Please connect brake wire to power single when motor frequency converts. Motor must match a separate fan when run under 30Hz.

输出轴允许最大轴径 Available Max Output Shaft Diameter

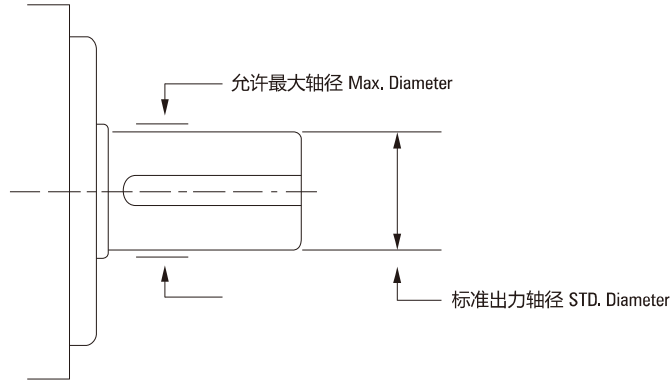

齿轮箱型号 Gear Box	标准出力轴径 Standard Output Shaft Dia	最大允许直径 Max Available Shaft Dia	输出端轴承 Output End Bearing
1#	Φ18	Φ20	6004
2#	Φ22	Φ25	6205
3#	Φ28	Φ30	6206
4#	Φ32	Φ35	6207
5#	Φ40	Φ45	6209
6#	Φ50	Φ55	6211

减速电机各零件部分大致说明 Main Parts Notes

部件名称 Parts Name	说明 Notes
箱体 Gearbox	1#、2#、3#、4#箱体出轴直径为18、22、28、32，箱体采用铝合金，5#、6#箱体出轴直径为40、50，箱体采用铸铁。 The output shaft diameter of gearbox 1#、2#、3#、4# are 18、22、28、32 separately. The material of gearbox is Al. alloy. 5#、6# are 40、50 respectively. Gearbox is made of cast iron.
齿轮片 Gear Piece	齿轮材料为40Cr，调质HB280，高精度滚齿，齿部高频淬火HRC50，齿面磨齿，齿轮精度6级。 The material 40Cr mixes to HB280, then dealt with high frequency quencher HRC50. Gear should be processed by milling with high precision. The class is 6.
齿轮轴 Gear Shaft	齿轮材料为20CrMnTi，高精度滚齿，渗碳淬火HRC60，齿面二次刮削，精度6级。 The material 20CrMnTi will be changed into HRC60 through processing of cementite quencher. Gear shaft will be processed with gear hobbing. Precision class is 6.
电机轴 Motor Shaft	齿轮材料为20CrMnTi，高精度滚齿，渗碳淬火HRC60，齿面二次刮削，精度6级。 The material 20CrMnTi will be changed into HRC60 through processing of cementite quencher. Gear shaft will be processed with gear hobbing. Precision class is 6.
轴承 Ball Bearing	电机部分轴承采用高精度等级精密轴承，以确保长期运转寿命。 We adopt tight bearing with high precision, to make sure longterm running life.
油封 Oil Seal	电机轴以耐高温油封为主，可有效防止油脂渗漏。 Gear shaft gives priority to enduring high temp, avoiding oil infiltration.
接线盒 Terminal Box	有两种：一种是铝合金接线盒，有较好的防水及防尘性能，防护等级为IP54。 另外一种是铁壳的接线盒，结构轻巧，防护等级IP20。 Two type. One is Al alloy, which equipes good capability of waterproof and dustproof. Protection grade is Ip54. The other is steel case with deft structure. Protection grade is IP20.

产品结构图
DETAILS PARTS LIST

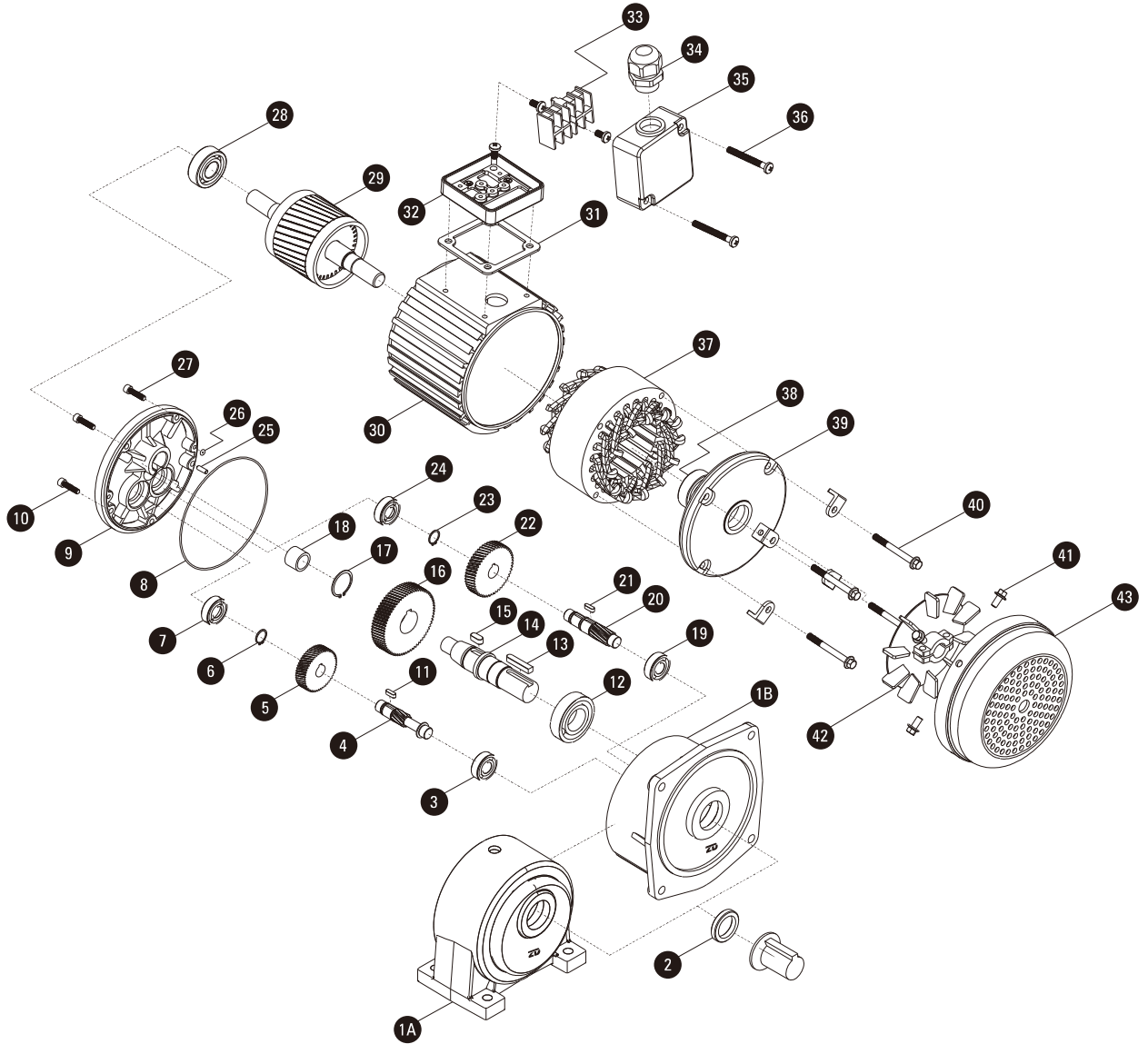

明细表 Parts List

序号 Item	名称 Name	序号 Item	名称 Name	序号 Item	名称 Name
1A	卧式 Horizontal Housing	15	三级小齿轴键 Key-3RD Pinion	30	机壳 Shell
1B	立式 Vertical Housing	16	三级大齿轮 Gear-3RD Stage	31	密封垫 A Seal
2	输出轴油封 Oil Seal-output Shaft	17	C-挡圈 Snap Ring	32	接线盒底座 Junction Box Base
3	二级齿轴承 Bearing-2ND Stage Pinion	18	输出轴自润滑轴承 Oilless Bearing	33	接线端子 Terminal Block
4	二级小齿轴 Pinion-3ND Stage	19	二级齿轴承 Bearing-2ND Stage Pinion	34	锁紧器 Locking Device
5	一级大齿轮 Gear-1ST Stage	20	三级小齿轴 Pinion-2ND Stage	35	接线盒盖 Junction Box
6	C-挡圈 Snap Ring	21	三级小齿轴键 Key-3RD Stage Pinion	36	固定螺钉 Fixed Screw
7	二级齿轴承 Bearing-2ND Stage Pinion	22	二级大齿轮 Gear-2RD Stage	37	定子总成 Stator
8	O型圈 Oil Ring	23	C-挡圈 Snap Ring	38	电机轴承 Bearing Of Shaft
9	电机前盖 Front Cover	24	三级齿轴承 Bearing-3ND Stage Pinion	39	后端盖 Back Cover
10	内六角螺钉 Hex-head Screw	25	定位销 Pin	40	固定螺栓 Fixed Bolt
11	二级小齿轴键 Key-2RD Stage Pinion	26	O型圈 Oil Ring	41	内六角螺钉 Hex-head Screw
12	输出轴承 Bearing-output Shaft	27	内六角螺钉 Hex-head Screw	42	风叶 Fan
13	输出轴键 Key-output Shaft	28	电机轴承 Bearing of Shaft	43	风罩 Fan Cover
14	输出轴 Output Shaft	29	转子 Rotor		